

Retracta 2



features & benefits

*Elegance and simplicity in a banner stand!
31" retractable banner stand/w adhesive
top rail & bag which features a full tele-
scopic pole and snap-on foot.*

RTRC-2

hardware specifications	graphic specifications	additional info
Max height: 83.75 Foot print: 33" X 14.5"	31"w x 77.5"h + 1/2" bleed at the top and 6" bleed at the bottom	Shipping weight: 6.75 lbs. Shipping dim: 37" x 11" x 16"

We are continually improving and modifying our product range and reserve the right to vary the specifications without prior notice. All dimensions and weights quoted are approximate and we accept no responsibility for variance. E&OE.

Assembly Instructions

Graphic Application



1 Remove paper backing from the tape on the graphic rail.



2 Hover top of the graphic over the graphic rail to line up the graphic and graphic rail. (back of graphic attaches to graphic rail)



3 Remove paper backing from the tape on the leader strip.



4 Attach the bottom of the graphic to the leader strip (back of graphic attaches to leader strip.)

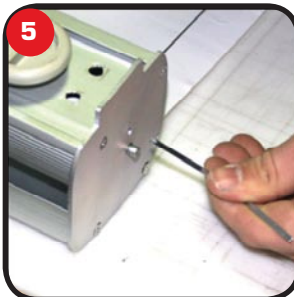

5 With a firm secure hold on the graphic remove graphic roller pin.



6 Slowly retract graphic into the unit making sure it is straight.

Unit Instructions



1 Remove pole from pole compartment on the unit.



2 Secure the stabilizing feet at 90° position to the unit.



Assemble poles

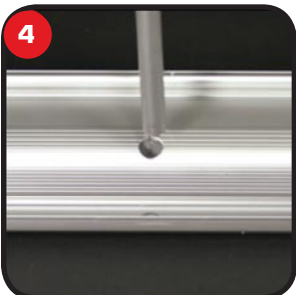

4 Secure pole onto the pole pin.



5 Gently un-retract graphic from unit.



6 Secure the graphic rail to the top of the pole.

Repeat steps in reverse to retract and Store